

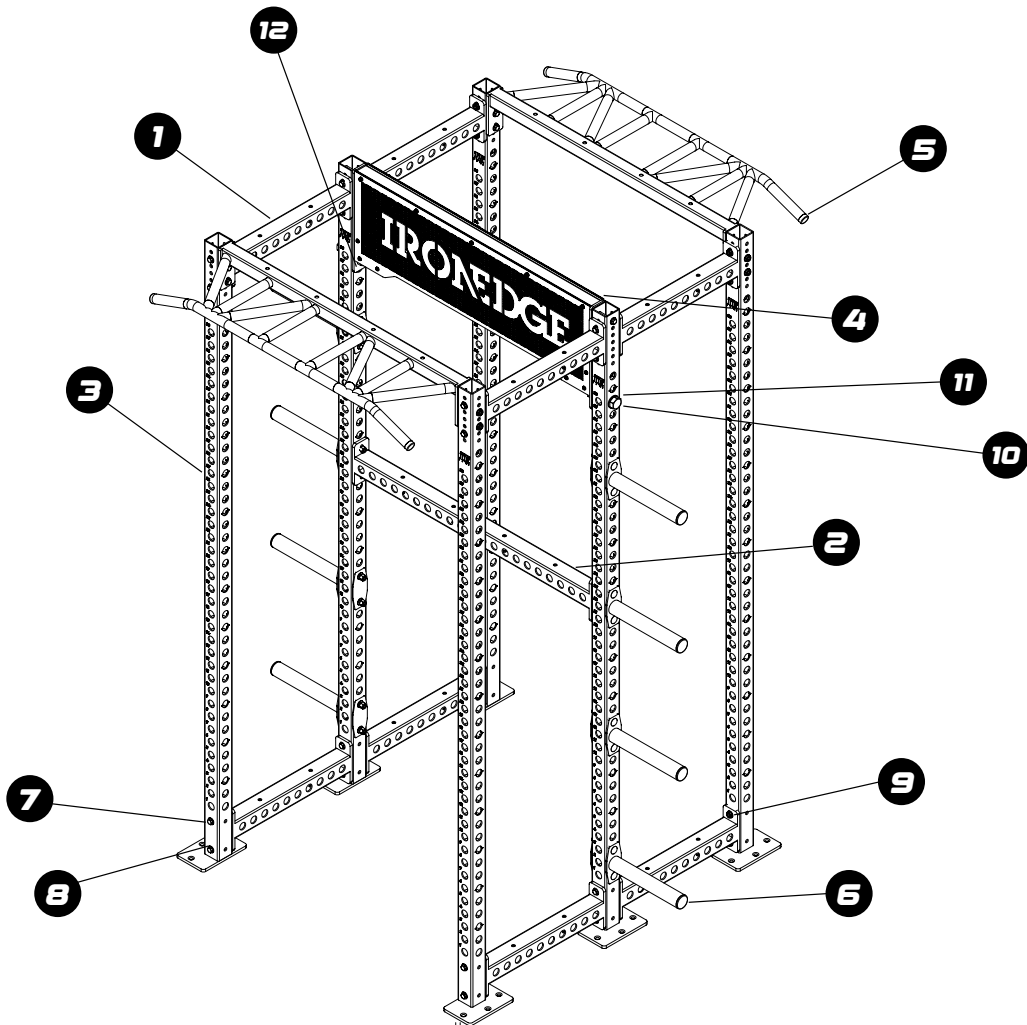

IRONEDGE.

IRON CAGE COMPACT DOUBLE



IRONEDGE

ASSEMBLY COMPONENTS

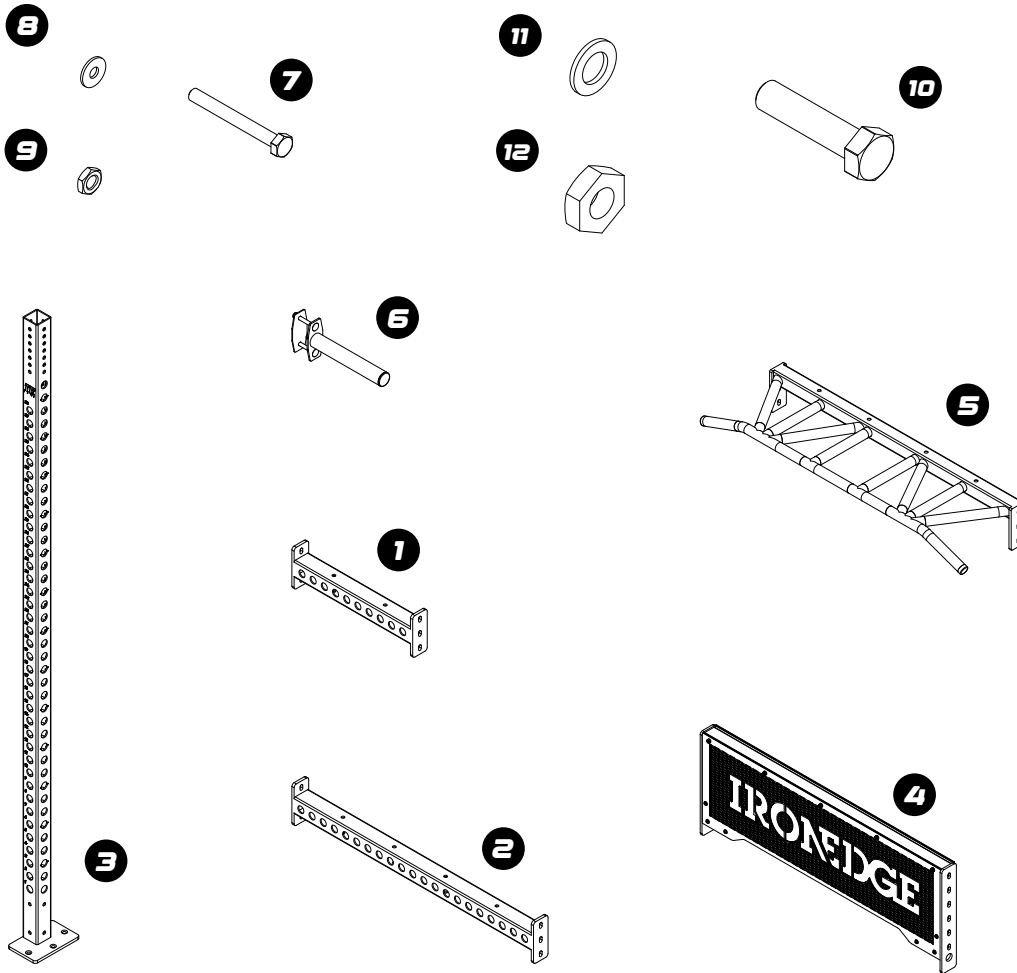

IRONEDGE

ASSEMBLY COMPONENTS

IRONEDGE | IRON CAGE COMPACT DOUBLE

PART NO.	COMPONENT NAME	QUANTITY
1	Crossbeam 540mm	4
2	Crossbeam 1080mm	1
3	Upright	6
4	Iron Edge Name Badge	1
5	Multigrip	2
6	Storage Pin (Pair)	4
7	M10 Hex Bolt	34
8	M10 Washer	68
9	M10 Nut	32
10	M23 Hex Bolt	2
11	M23 Washer	4
12	M23 Nut	2

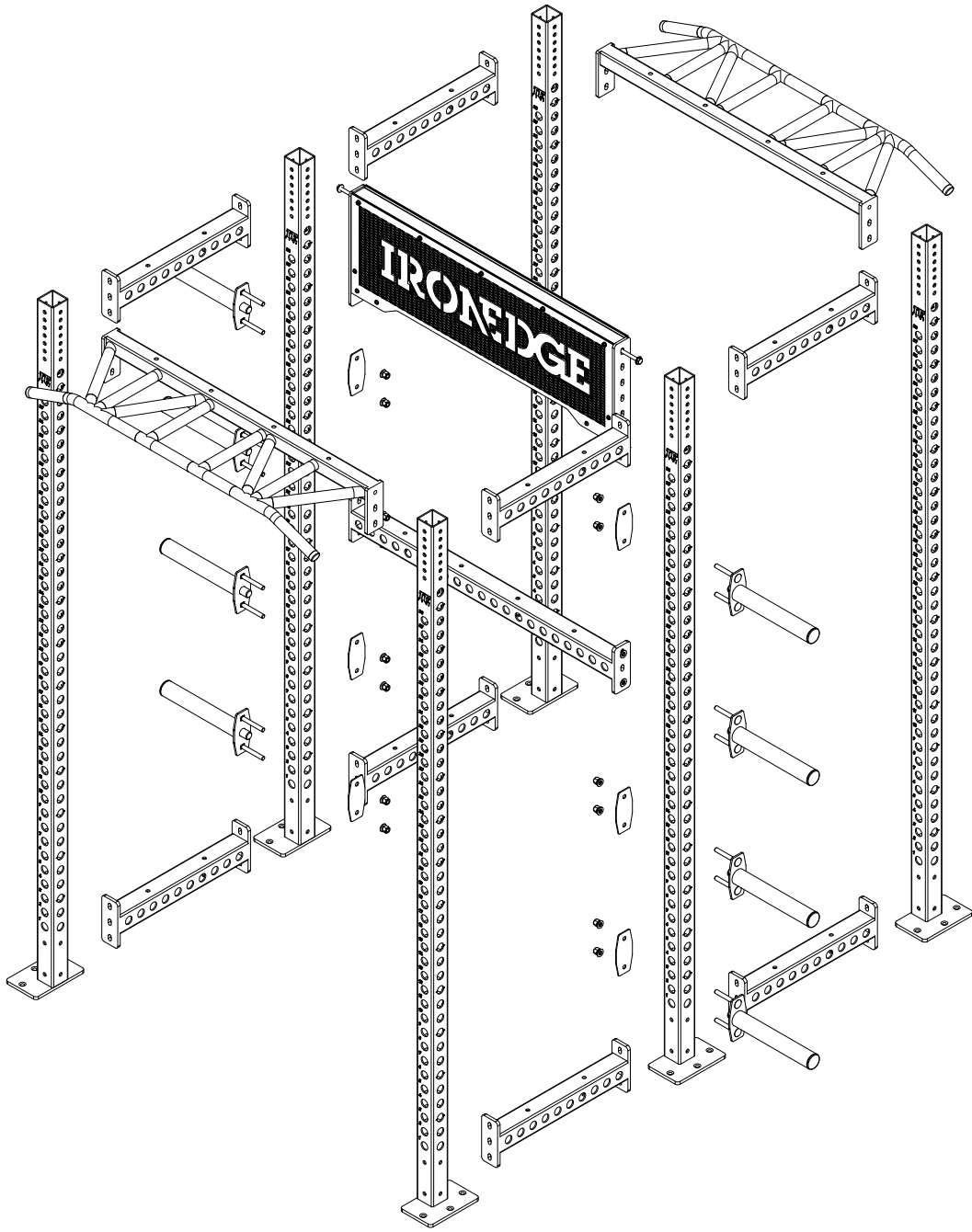

IRONEDGE

ASSEMBLY INSTRUCTIONS

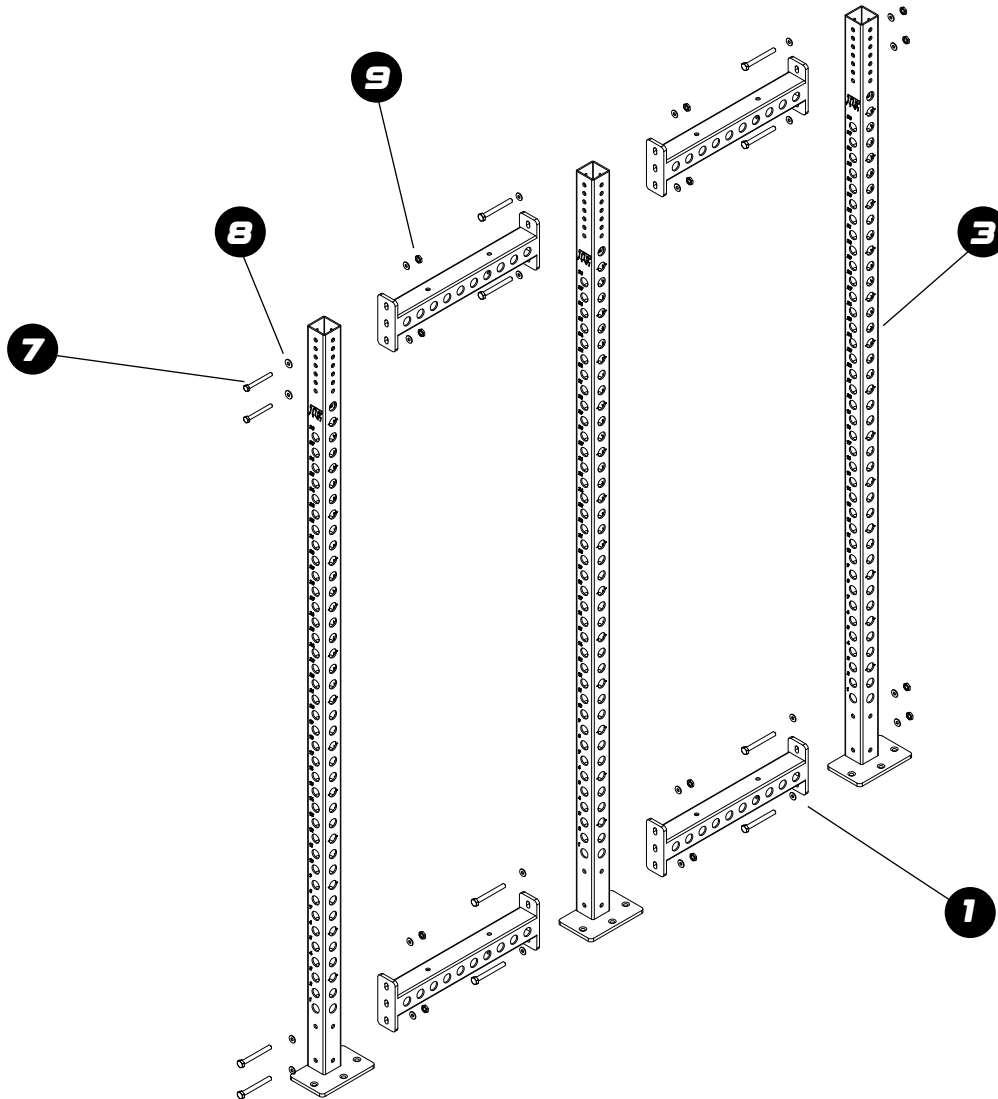

1

IRONEDGE

**ASSEMBLY
INSTRUCTIONS**

Attach the 540mm Crossbeam (1), to two Uprights (3), using M10 fasteners (7, 8, 9).

Align the brackets with the second-highest holes on the Uprights for the top Crossbeam.

Repeat to create a second assembly.

Ensure all fasteners are secure and the assemblies are stable.

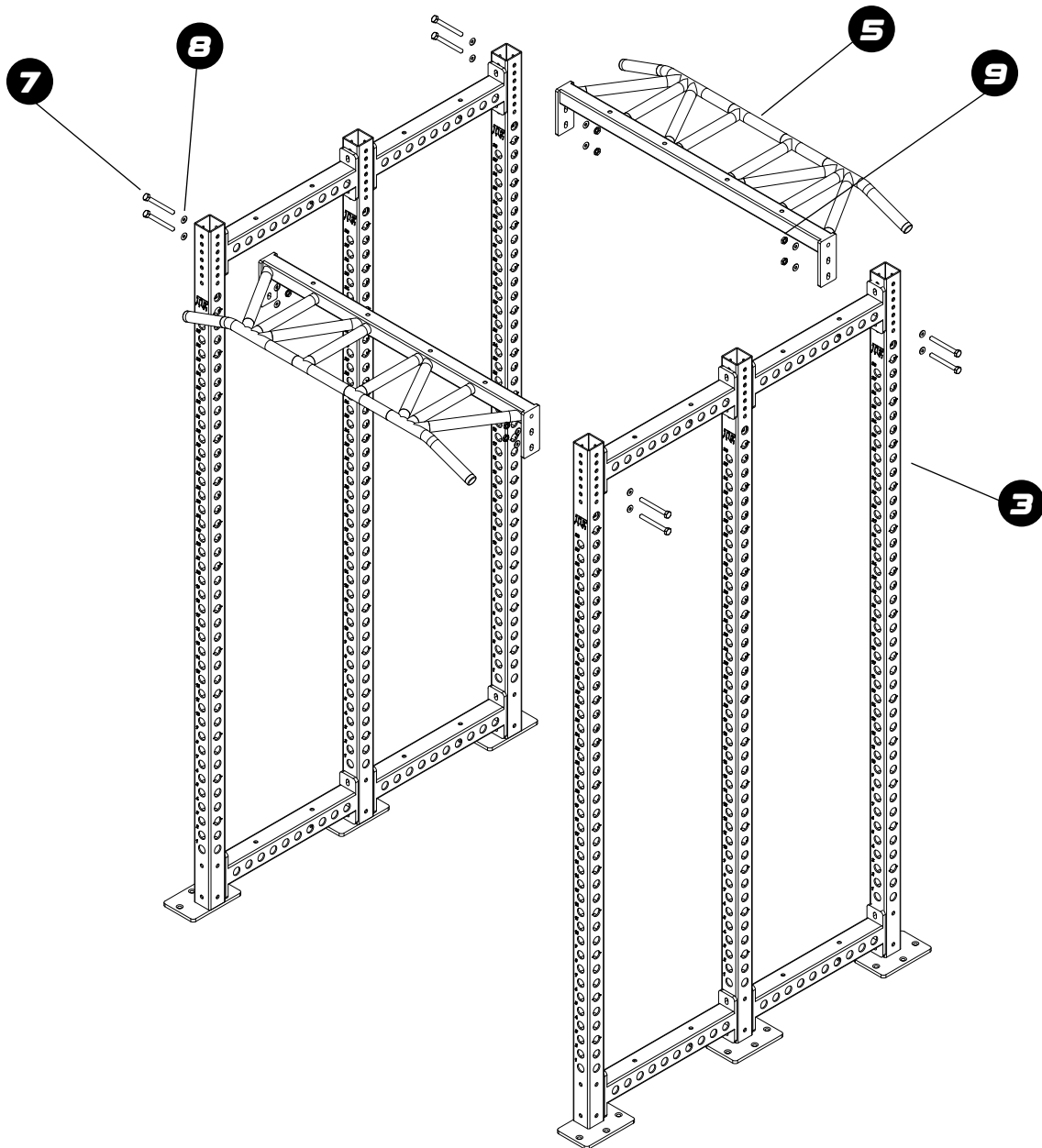

2

IRONEDGE

ASSEMBLY INSTRUCTIONS

Attach the Multigrips (5), to the Uprights (3), using the M10 fasteners (7, 8, 9).

Align them flush with the top of the Uprights and secure through the 3rd and 5th holes from the top.

Ensure both Multigrips are tightly fastened for stability.

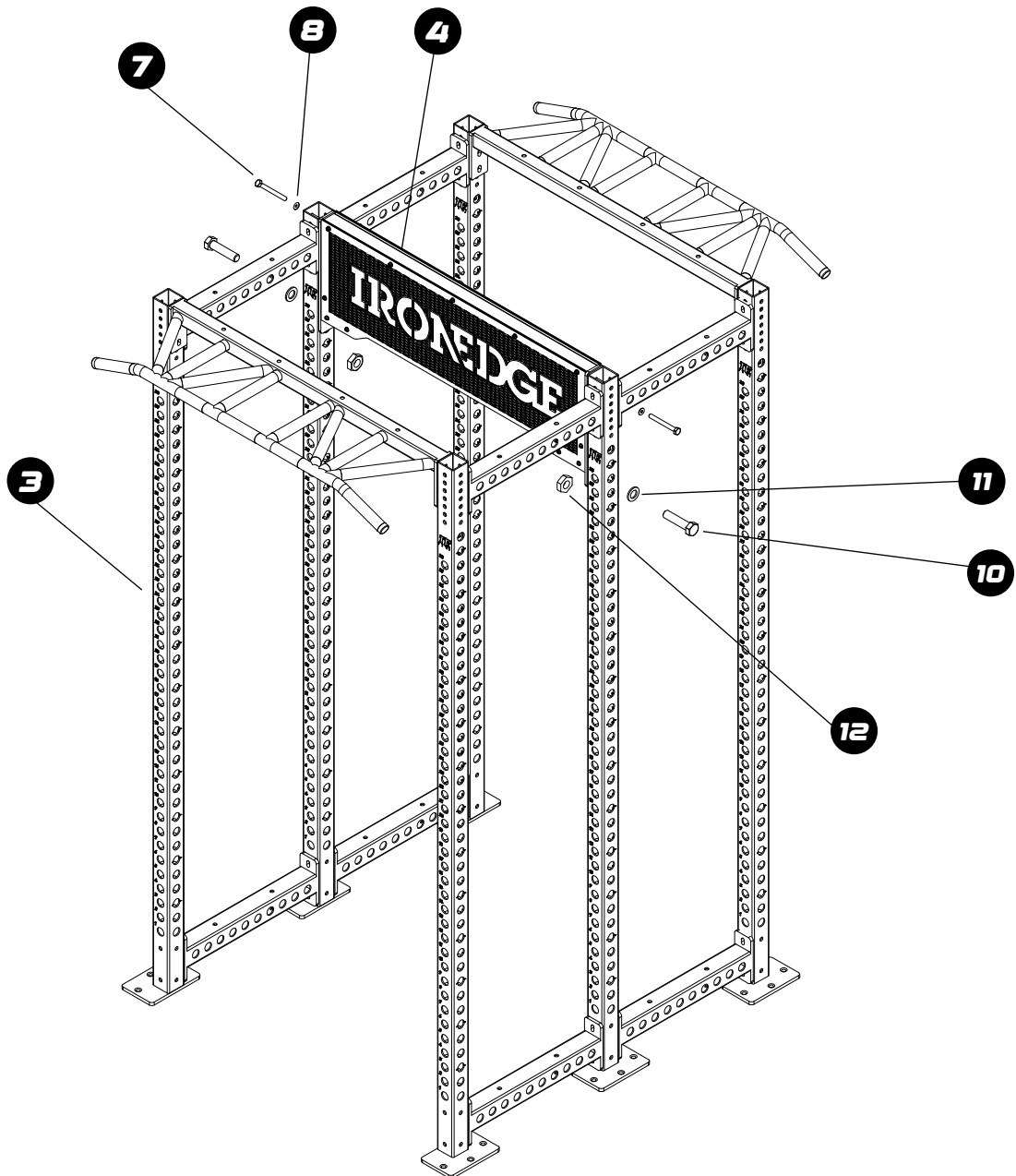

3

IRONEDGE

**ASSEMBLY
INSTRUCTIONS**

Align the Iron Edge Name Badge (4) to the top of the Uprights (3).

Using M10 fasteners (7, 8, 9), thread the bolt through the washer and into the Name Badge bracket to hold it in place.

Once secured, use the M23 set (10, 11, 12), to fasten it into the large hole on the Upright (3) that aligns with the bracket (4).

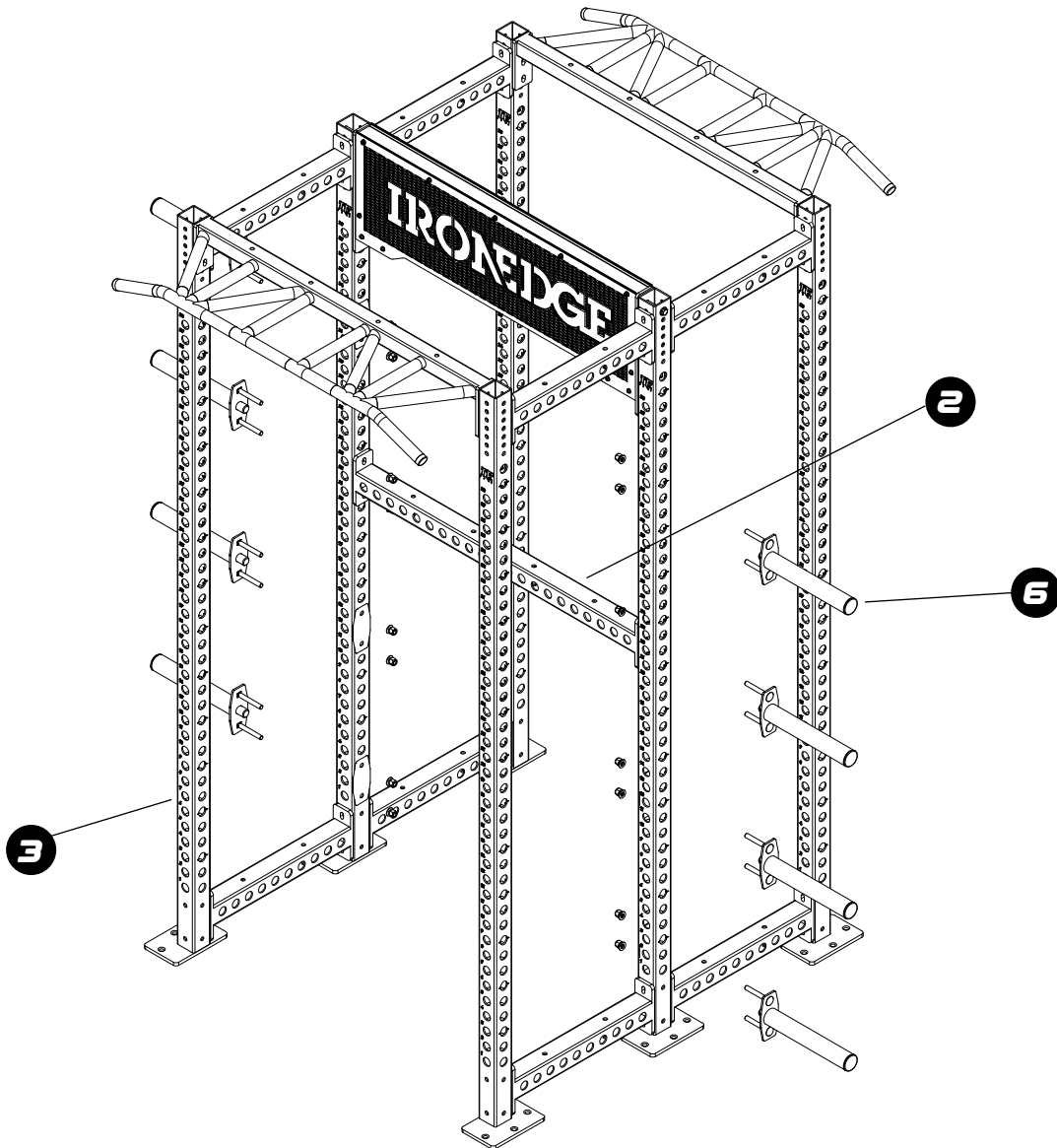

4

IRONEDGE

**ASSEMBLY
INSTRUCTIONS**

Insert the stub of each Storage Pin (6), into the holes on the Uprights (3), labeled 2, 12, 22, and 32.

Align the bracket holes with the second plate of the Storage Pins (6), and fasten using the provided bolt set (6).

For the Storage Pin (6), at position 22, align the 1080mm Crossbeam (2), instead of the bracket and secure it using the same bolt set from the Storage Pins (6).

IRONEDGE®